

Cabinet "U" handles

Aluminium

SPECIFICATION

Aluminium

plastic coated

black, RAL 9005, UV-resistant, textured finish **SW**

red, RAL 3000, textured finish **RS**

silver, RAL 9006, textured finish **SR**

anodized, neutral colour **EL**

blank, ground **BL**

INFORMATION

GN 565.1 cabinet „U“ handles are made from a bent aluminum profile and have excellent stability and ergonomic design. Due to the production process, special designs can be supplied even in relatively small quantities.

In addition to the standard surfaces, these cabinet „U“ handles are also available with a functional coating.

The **SW** version is coated with a highly weather-resistant and UV-protective powder coating system, making this version excellent for outdoor use.



TECHNICAL INFORMATION

- Load rating information (see page A35)

Bore for
socket cap screw
DIN 912-M5 / M6

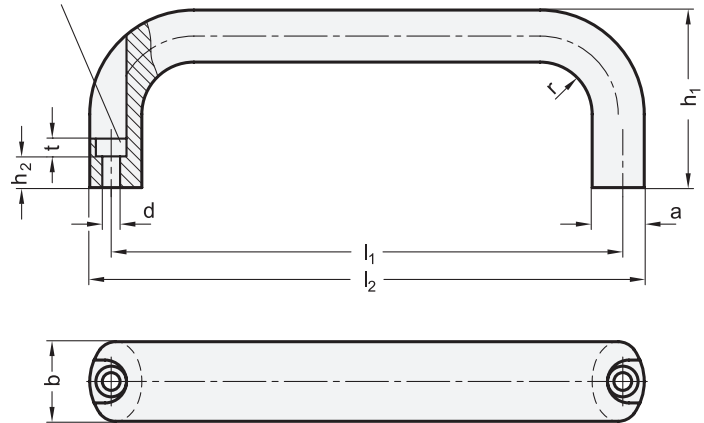

* Complete with colour index of the Cabinet "U" handles (SW, RS, SR, WSA, EL or BL)

| | | | | |
|-----------|-----------|-----------|-----------|-----------|
| SW | RS | SR | EL | BL |
| RAL9005 | RAL3000 | RAL 9006 | anodized | blank |

GN 565.1

| Description | b | l1 ±0.25 | a | d | h1 | h2 | l2 | r | t | ⚖️ |
|-------------------|----|----------|----|-----|----|------|-----|----|-----|-----|
| GN 565.1-20-100-* | 20 | 100 | 13 | 5.4 | 49 | 13.5 | 112 | 13 | 5.5 | 80 |
| GN 565.1-20-112-* | 20 | 112 | 13 | 5.4 | 49 | 13.5 | 124 | 13 | 5.5 | 87 |
| GN 565.1-20-117-* | 20 | 117 | 13 | 5.4 | 49 | 13.5 | 129 | 13 | 5.5 | 89 |
| GN 565.1-20-120-* | 20 | 120 | 13 | 5.4 | 49 | 13.5 | 132 | 13 | 5.5 | 90 |
| GN 565.1-20-128-* | 20 | 128 | 13 | 5.4 | 51 | 13.5 | 140 | 13 | 5.5 | 100 |
| GN 565.1-20-160-* | 20 | 160 | 13 | 5.4 | 51 | 13.5 | 172 | 13 | 5.5 | 120 |
| GN 565.1-26-116-* | 26 | 116 | 17 | 6.4 | 55 | 11 | 130 | 17 | 6 | 145 |
| GN 565.1-26-120-* | 26 | 120 | 17 | 6.4 | 55 | 11 | 134 | 17 | 6 | 149 |
| GN 565.1-26-132-* | 26 | 132 | 17 | 6.4 | 55 | 11 | 146 | 17 | 6 | 160 |
| GN 565.1-26-164-* | 26 | 164 | 17 | 6.4 | 57 | 11 | 178 | 17 | 6 | 200 |
| GN 565.1-26-179-* | 26 | 179 | 17 | 6.4 | 57 | 11 | 193 | 17 | 6 | 220 |
| GN 565.1-26-196-* | 26 | 196 | 17 | 6.4 | 57 | 11 | 210 | 17 | 6 | 226 |

